

# Phelps Value Analysis

September 15, 2020

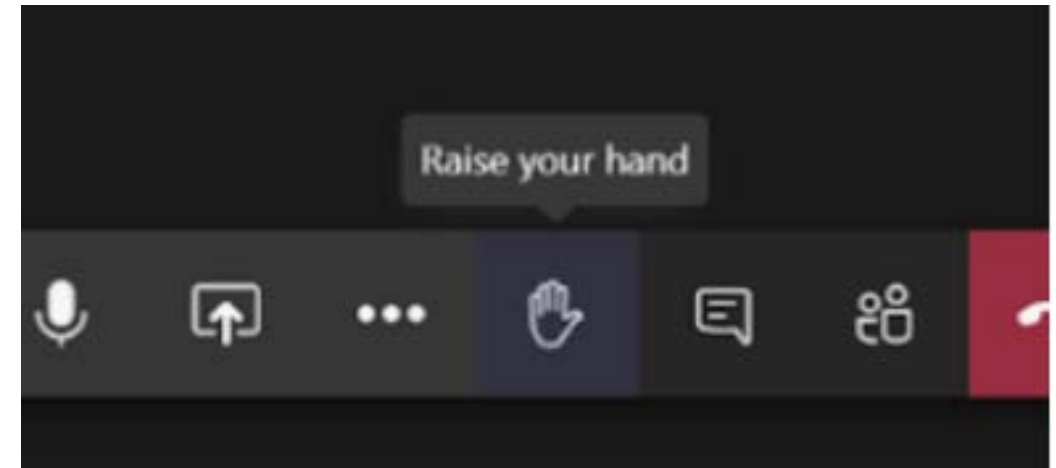

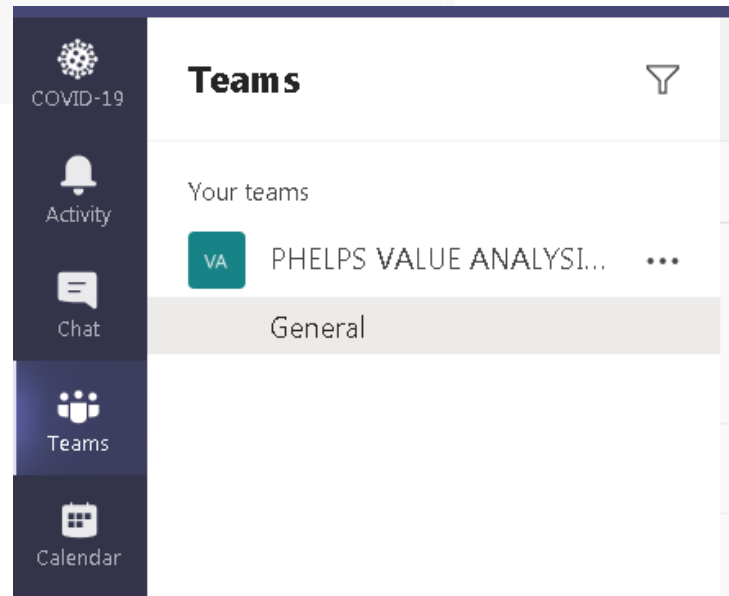



Recall / Safety Report	RECALLS REPORTED AT SAFETY COMMITTEE MEETING				
Month Reporting	JULY 2020				
Reported On:	<a href="#">Click here to enter a date.</a>				
Reported By:	Giovanna Conti - Robles				
Description of Equipment / Product Recalled	Date Posted	Manufacture	Class	Type of Action	Date Status Updated
NRAC ID: 143247  FDA ID: D-1376-2020  Product 1: Zilretta (triamcinolone acetonide extended-release injectable suspension), 32mg per vial, 5mL vials, Single-dose Kits, Rx Only NDC: <ul style="list-style-type: none"> <li>70801-003-01</li> </ul> Lot Number: <ul style="list-style-type: none"> <li>ZA19014</li> </ul> Expiration Date: 5/31/2021	7/10/2020	Flexion Therapeutics, Inc, Burlington, MA	Class 2	Type of Action: Update to Prior Notice  Reason: This is an update to recall number D-1376-2020 posted on 7/8/20 to include nationwide distribution. Temperature Abuse: Product was stored at room temperature longer than six weeks and was inadvertently distributed instead of discarded.  Action: Quarantine and contact your supplier for instructions	7/13/2020  10:53 AM Christine Matusiak Quarantined  Have product (recall)

Recall / Safety Report	RECALLS REPORTED AT SAFETY COMMITTEE MEETING				
Month Reporting	AUGUST 2020				
Reported On:	<a href="#">Click here to enter a date.</a>				
Reported By:	Giovanna Conti - Robles				
Description of Equipment / Product Recalled	Date Posted	Manufacture	Class	Type of Action	Date Status Updated
NRAC ID: 143356  FDA ID: To be determined  Product 1: Imager II Angiographic Catheter - 5 French Curved Tip Shapes  Assorted part and lot # listed on NRAC site	8/6/2020	Boston Scientific Corp, Marlborough, MA	Class TBD	Type of Action: Update to Prior Notice (142601)  Reason: This is an update to recall number Z-1555-2020 posted on 2/18/2020 to include all lots/batches of this 5F configuration. Boston Scientific has identified an increase in the rate of tip detachment complaints.  Action: Quarantine and return affected product for credit. Consider both the inner and outer packaging UPN codes when searching for affected product, as the UPN numbers on the inner and outer labeling are different. With questions contact your local sales representative	8/7/2020 7:39 AM Anne Marie Driscoll Once a Month In Progress  8/12/2020 12:57 PM Anne Marie Driscoll Have affected product. Removed from shelf and quarantined. Sent to materials ops for return. -ad

NRAC ID: 143441  FDA ID: Z-2872-2020  Product 1: C-Arm Fluoroscopic X-ray System  Model Number: <ul style="list-style-type: none"> <li>• OEC 9800</li> <li>• OEC 9900 Elite</li> </ul>	8/28/2020	GE Healthcare, Salt Lake City, UT	Class 2	Type of Action: Defective Product Recall  Reason: GEHC Surgery became aware that some users of the 9800 and 9900 fluoroscopic mobile C-Arms within the United States had requested that a Field Service Engineer (FSE) change the dose value on the live update screen from AKR/CAK to DAP. All systems sold to customers in the US that leave GEHC Surgery (the place of manufacture) are configured to display AKR/CAK when they leave the factory. An FSE changing the dose display, per the customer request, to display DAP instead does not comply to 21CFR 1020.32(k), which requires fluoroscopic equipment manufactured on or after June 10, 2006 to display continuous updates of AKR and CAK values.  Action: With questions call Troy Perry at 801-536-4890.	9/3/2020  12:53 PM Janet Pierce  Completed  systems are up to date
--	-----------	-----------------------------------	---------	--	---

- There are currently **194 recalls** that have to be addressed.
- General rule is to respond to the recalls the day it was received or within 1-2 days.
- If you need time to review the recall and your supplies you can update the status to “in progress” and that will stop the clock.
- NRAC will remind you via email to review.
- **Class 1 recalls** are to be responded to within 1 day since there is a reasonable probability that the use the affected product may cause serious injury or death.







Click to enlarge. To view full image, [click here](#)

## Standard Surgical Masks

Manufacturer: Medline

- Surgical masks engineered to provide protection and ensure comfort and breathability
- BFE > 98%, PFE > 97%

For your business 

To view pricing and availability

Login



## AQUACEL® Ag Advantage

AQUACEL® Ag Advantage dressings are antimicrobial primary dressings for use in chronic and acute wounds that are infected or at risk of infection with varying exudate levels. AQUACEL® Ag Advantage dressings incorporate two powerful technologies working together to help eliminate the key barriers to healing: exudate, infection and bioburden.



Support &gt;

Contact  
Us >

## NEONATAL, RESPIRATORY



## T-Piece Resuscitation Circuit

IFU/DFU

The Neo-tee T-Piece Resuscitator is a gas powered emergency resuscitator intended to provide emergency respiratory support by means of a face mask or a tube inserted into a patient's airway. It is intended for use with neonates and infants weighing less than 10kg (22lb).

**Manufacturer:** Mercury  
Medical

Prod. No	Unit	Part Name
1050900	10/Box	T-Piece Resuscitation Circuit Only – 6 ft Length, No Manometer, No Mask
1050901	10/Box	T-Piece Resuscitation Circuit, Anatomical Infant Cushion Face Mask, No Manometer, 6ft Length
1050902	10/Box	T-Piece Resuscitation Expandable Circuit Only – 5 ft Length, No Manometer, No Mask

July 15, 2020

Teleflex

3015 Carrington Mill Blvd  
Morrisville, NC 27560  
USA  
teleflex.com  
cs@teleflex.com

**Subject: Upcoming Packaging Changes to Select Arrow® Brand Kits**

Dear Valued Customer,

In our ongoing commitment to maximize the clinical benefits of our products we are implementing packaging changes to the pre-filled saline syringes included with the Arrow® Brand Kits your institution currently purchases.

Beginning in September, the pre-filled saline syringes currently affixed to the external primary kit packaging will be moved inside the primary packaging, within the sterile barrier wrap of the procedural tray.

Additionally, sealed foiled pouches will replace the existing peel-away packaging of each pre-filled saline syringe, facilitating procedural efficiency through a clinician focused, easy open design.

Existing peel-away packaging:

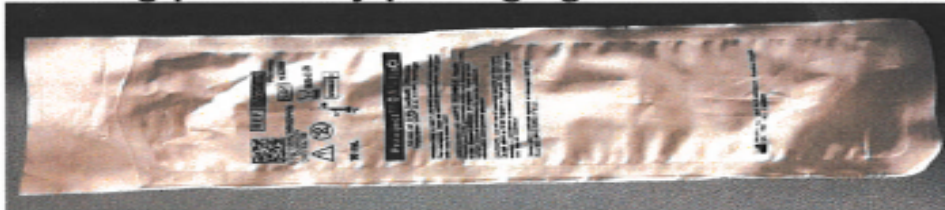

New sealed foiled pouch:



**Affected SKUs include select:** (See Appendix A)

- Arrow® PICC Kits
- Arrow® Midline Kits
- Arrow® JACC Kits
- Arrow® Central Venous Catheterization Kits
- Arrow® Acute Hemodialysis Kits
- Arrow® Percutaneous Sheath Introducer Kits
- Arrow® Multilumen Catheter (MAC) Kits

ITEM_ID	ITEM_DESCR	MFG_DESCR	MFG_CATALOG
<a href="#">000000000000122023</a>	STERILE PROCEDURE KITS FH	MEDLINE INDUSTRIES INC	DT14965
<a href="#">000000000000133571</a>	PICC TRAY INSERTION PACK CA/12	MEDLINE INDUSTRIES INC	DYNJSPICC1
<a href="#">000000000000183888</a>	KIT DRSG CHNG CVC PED CHG 50CA	MEDLINE INDUSTRIES INC	DT16575
<a href="#">000000000000191028</a>	KIT INSERTION UNIVERSAL 15EA/CA	MEDLINE INDUSTRIES INC	CVI2570
<a href="#">000000000000196267</a>	KIT DRSG CVC SORBAVIEW BIOPATCH 50/CA	MEDLINE INDUSTRIES INC	DT18575
<a href="#">000000000000196268</a>	KIT DRSG DIALYSIS SORBAVIEW BIOPATCH 50/CA	MEDLINE INDUSTRIES INC	DT18580
<a href="#">000000000000200604</a>	KIT INSTRUMENT UMB/PICC	MEDLINE INDUSTRIES INC	UVT515
<a href="#">000000000000201541</a>	KIT CATH INSERTION	MEDLINE INDUSTRIES INC	DT22035
<a href="#">000000000000222367</a>	KIT MIDLINE INSERTION PHELPS ONLY	MEDLINE INDUSTRIES INC	DYNJ45178
<a href="#">000000000000226910</a>	DRIVELINE MANAGEMENT SYSTEM WEEKLY LVAD	MEDLINE INDUSTRIES INC	DM740
<a href="#">000000000000240211</a>	KIT CNTRL LINE W/BOPATCH	MEDLINE INDUSTRIES INC	DT15165
<a href="#">000000000000240211</a>	KIT CNTRL LINE W/BOPATCH	MEDLINE INDUSTRIES INC	DT15165
<a href="#">000000000000247022</a>	KIT CVC MULTI-LUMEN 5/CA	MEDLINE INDUSTRIES INC	ECVC5015
<a href="#">000000000000256677</a>	KIT DRSG DRIVELINE MANAGEMENT WEEKLY	MEDLINE INDUSTRIES INC	DT18155





CURRENT

Cardinal ENFit Cross

PS #	PS ITEM DESCRIPTION	VENDOR	MFG	MFG CATALOG #	STD UOM	PO UOM	ANNUAL QTY (CASE)	IDC ITEM	ITEM DESCRIPTION	CATALOG #
000000000 000003918	TUBE FEED INF 8FR 15 IN	CARDINAL	BARD	36410	EA	BX	17	Y	Feeding Tube, Radiopaque Line, Neonatal/Pediatric, 8FR, 20IN	461701
000000000 0000229331	TUBE FEEDING PVC 10 FR 42IN	CARDINAL	CARDINAL	460208	EA	CA	4	N	Feeding Tube, Radiopaque Line, Neonatal/Pediatric, 10FR, 42IN	460208E
000000000 000175368	TUBE FEEDING 8FR 42 50/CA	CARDINAL	CARDINAL	460406	CA	CA	1	N	Feeding Tube, Radiopaque Line, Neonatal/Pediatric, 8FR, 42IN	460406E
000000000 000001259	TUBE FEED 8FRX16IN BX/50	CARDINAL	CARDINAL	460604	EA	CA	9	N	Feeding Tube, Radiopaque Line, Neonatal/Pediatric, 8FR, 16IN	460604E
000000000 000001462	TUBE FEED PVC 5FRX16IN BX/50	CARDINAL	CARDINAL	460802	EA	CA	6	Y	Feeding Tube, Radiopaque Line, Neonatal/Pediatric, 5FR, 16IN	460802E
000000000 000175369	TUBE FEEDING 5FR 50/CA	CARDINAL	CARDINAL	461008	CA	CA	3	N	Feeding Tube, Radiopaque Line, Neonatal/Pediatric, 5FR, 36IN	461008E
000000000 000140970	TUBE FEEDING INF 5 FR 15 FR	CARDINAL	BARD	36400	EA	CA	4	N	Feeding Tube, Radiopaque Line, Neonatal/Pediatric, 5FR, 36IN	461503E
000000000 0000229008	TUBE FEEDING 8FRX36IN	CARDINAL	CARDINAL	8884720825	EA	CA	1	N	Feeding Tube, Radiopaque Line, Rigid Port Stylet, 3G Weighted Tip, 8FR, 36IN	8884720825E
000000000 000059379	TUBE FEED ENTERAL 8FR BX/10	SAVOY	AVANOS	20-5438	EA	BX	71	N	Feeding Tube, Radiopaque Line, Rigid Port Stylet, 3G Weighted Tip, 8FR, 55IN	8884720858E
000000000 000059380	TUBE FEED ENTERAL 10FR BX/10	SAVOY	AVANOS	20-5431	EA	CT	291	Y	Feeding Tube, Radiopaque Line, Rigid Port Stylet, 5G Weighted Tip, 10FR, 43IN	8884721088E
000000000 000059222	TUBE FEED 10FR BULLET TIP CA10	CARDINAL	CARDINAL	8884721088	EA	CA	5	N	Feeding Tube, Radiopaque Line, Rigid Port Stylet, 5G Weighted Tip, 10FR, 43IN	8884721088E
000000000 000059383	TUBE FEED 12FR BULLET TIP CA10	CARDINAL	CARDINAL	8884721252	EA	CA	298	Y	Feeding Tube, Radiopaque Line, Rigid Port Stylet, 5G Weighted Tip, 12FR, 43IN	8884721252E
000000000 000004614	TUBE FEEDING KANGAROO 12FR 36IN (dual port)	CARDINAL	CARDINAL	8884711501	EA	CA	163	N	No ENFit Cross	

PS# 204614

Usage 7/15/2019 - 7/14/2020

ITEM ID	ITEM DESCR	FACILITY
000000000 000204614	TUBE FEEDING KANGAROO 12FR 36IN	SIUHN NRSRG - ICU
000000000 000204614	TUBE FEEDING KANGAROO 12FR 36IN	SIUHN NRSRG - CCU
000000000 000204614	TUBE FEEDING KANGAROO 12FR 36IN	SIUHN NRSRG - Vent Unit
000000000 000204614	TUBE FEEDING KANGAROO 12FR 36IN	SIUHS NRSRG - ICU/CCU
000000000 000204614	TUBE FEEDING KANGAROO 12FR 36IN	SIUHN OP Svc - ER
000000000 000204614	TUBE FEEDING KANGAROO 12FR 36IN	SIUHN NRSRG - Rehab 4A
000000000 000204614	TUBE FEEDING KANGAROO 12FR 36IN	SIUHN Sup Svc - Patient Dist
000000000 000204614	TUBE FEEDING KANGAROO 12FR 36IN	SIUHS NRSRG - 4N/4S
000000000 000204614	TUBE FEEDING KANGAROO 12FR 36IN	SIUHN NRSRG - CTU
000000000 000204614	TUBE FEEDING KANGAROO 12FR 36IN	SIUHN NRSRG - 3B
000000000 000204614	TUBE FEEDING KANGAROO 12FR 36IN	SIUHN Cardiac Catheterization
000000000 000204614	TUBE FEEDING KANGAROO 12FR 36IN	SIUHN NRSRG - 3C
000000000 000204614	TUBE FEEDING KANGAROO 12FR 36IN	SIUHN NRSRG - 4C
000000000 000204614	TUBE FEEDING KANGAROO 12FR 36IN	SIUHN NRSRG - 3A
000000000 000204614	TUBE FEEDING KANGAROO 12FR 36IN	SIUHN NRSRG - Burn Unit
000000000 000204614	TUBE FEEDING KANGAROO 12FR 36IN	SIUHN NRSRG - Pediatrics 3D
000000000 000204614	TUBE FEEDING KANGAROO 12FR 36IN	SIUHN NRSRG - 4B
000000000 000204614	TUBE FEEDING KANGAROO 12FR 36IN	SIUHS OP Svc - ER
000000000 000204614	TUBE FEEDING KANGAROO 12FR 36IN	SIUHN NRSRG - 3A

75%







## The Communicator™ Clear Window Surgical Mask (Box of 40)

★★★★★ (7 customer reviews)

\$60.00

**Model FM86000 |Box of 40 Masks**

**LIMITED QUANTITY | SHIPPING MID-SEPTEMBER**

Patented, FDA registered device meets ASTM Level 1 surgical mask standards with the added benefit of a fog-resistant clear window for improved communication.

Supported by Doctors, Nurses, Dentists, Hygienists, Orthodontists, Interpreters, and other Health Professionals seeking easier communication and exceptional protection.

### Product Features

- ASTM F2100 Level 1 Protection. >95% bacterial and particle filtration efficiency.
- Comfortable material with elastic earloops and adjustable nosepiece design.
- Not made with latex.
- Easy dispenser box containing 40 single-use, disposable masks.
- Made in the USA for guaranteed highest quality.
- Available exclusively from Safe'N'Clear, Inc.

PS#

FM86000	MASK FACE COMMUNICATOR CLEAR WINDOW ASTM LVL 1 40/BX	<a href="#">260160</a>
---------	--	------------------------

The only difference between the two products is the manifold. The 22703 has a double swivel elbow manifold and the 2270135 has a T piece manifold and separate swivel which attaches to the patient port. It also comes with a flex tube to allow an easy connection to the vent tubing. Other than this, they work exactly the same

n

AVANOS MEDICAL INC

Core | Contract # 0031010174 ⓘ

# BALLARD® Turbo-Cleaning Closed Suction System with TRACH CARE®, Double Swivel Elbow, 14FR

Material #: 22703

Manufacturer #: 22703

EA  
INELIGIBLE ⓘ

BX/10 EA  
\$148.99

CS/2 BX  
\$297.98

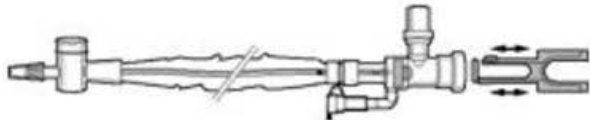

This item is currently backordered

# BALLARD® Turbo-Cleaning Closed Suction System, T-Piece, 14FR

Material #: 2270135

Manufacturer #: 2270135

EA  
INELIGIBLE ⓘ

BX/10 EA  
\$114.23

CS/2 BX  
\$228.45

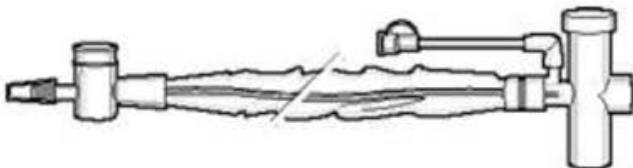

This item is currently backordered

QTY

1

Check Availability

Add to List

Add to Cart

## NORTHWELL HEALTH - OFFICE OF PROCUREMENT

8/3/2020

## PROJECTED SAVINGS FOR SYSTEM CONVERSION FROM SAGE TO HOVERMATT

## CURRENT SAGE ITEMS (AIRTAP and MATS)

## CROSS TO HOVERMATT 39IN LINK with (2) Z FLO POSITIONERS

PS#	DESC	EACH PRICE	CATALOG #	ANNUAL EACHES	ANNUAL AMOUNT	PS #	DESC	EACH PRICE	POTENTIAL NEW SPEND	POTENTIAL COST IMPACT	% SAVINGS
000000000 000230415	AIRTAP SYSTEM (MATTRESS 36IN, BODY PAD, 2 WEDGES)	\$ 174.08	7217	4195	\$ 730,265.60	246834	MATTRESS HOVERMATT LINK STRAPS 39IN	\$ 77.30	\$ 549,796.70	\$ 180,468.90	25%
						156869	POSITIONER ANCILLARY Z-FLO 12x20	\$ 53.76			
000000000 000235147	AIRTAP MATTRESS ONLY	\$ 133.12	7219	5830	\$ 798,771.20	246834	HOVERMATT 39IN LINK	\$ 77.30	\$ 450,659.00	\$ 348,112.20	44%
000000000 000226979	AIRTAP BODY PAD ONLY	\$ 3.12	7250	49590	\$ 154,886.10		NO BODY PAD REQUIRED WITH HOVERMATT	\$ -	0	\$ 154,886.10	100%
000000000 000235809	MATS SYSTEM (MATTRESS 39IN AND BODY PAD)	\$ 76.80	3242	5020	\$ 411,238.40	246834	HOVERMATT 39IN LINK	\$ 77.30	\$ 388,046.00	\$ 23,192.40	6%
					\$ 2,095,161.30				\$ 1,388,501.70	\$ 706,659.60	

# N95 Mask Issue Log

Unit -

*Halyard - Reg.*

*Halyard - Small*

*3M 8511 - Reg*

*Cardinal - Small*

	Date	Name (PRINT)				
1						
2						
3						
4						
5						
6						
7						
8						
9						
10						
11						
12						
13						
14						
15						
16						
17						
18						
19						
20						

# GUIDELINES FOR ISSUING N95 MASK

- ONLY use the attached form when issuing a mask to your staff.
- There should only be one person issuing the masks during each shift.
- Staff members should NOT sign for their masks.
- The issuer should be printing first & last name when issuing the mask.
- The inventory should be monitored daily to avoid weekend and rush replenishment.
- When requesting a replenishment of masks you may do the following:
  - Vocera Materials Operations and either speak to Giovanna Conti or Ricky Espinoza
  - Email the completed form to Giovanna Conti
- We will deliver ONLY the amount used according to the completed form.



Item	Descr	Mfg Itm ID	Descript
000000000000232797	PACK COLD MED 6X6 32 EA/CA	11445020B	CARDINAL HEALTHCARE



Item	Descr	Mfg Itm ID	Descript
0000000000000249268	PACK HOT MED 6X7.5IN	11450040B	CARDINAL HEALTHCARE







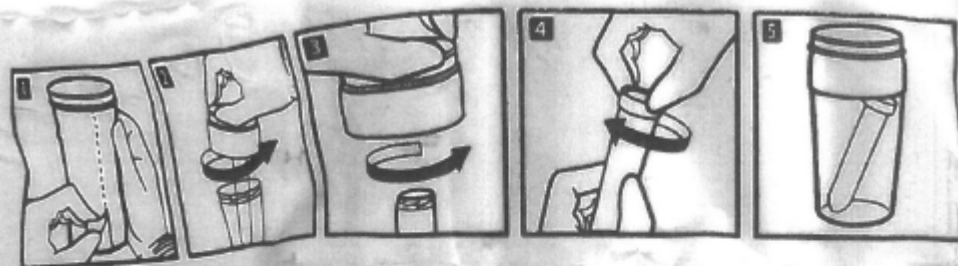

**Nurse/Technologist Instructions:**

1. After specimen is collected – remove plastic label from container by tearing along perforations.
2. Label container – place in appropriate specimen transport bag and forward to the lab.

**If Tube Only is to be Forwarded to Lab:**

1. After specimen is collected – remove plastic label from container by tearing along perforations.
2. Unscrew funnel section from the container.
3. Remove centrifuge tube and close tightly using the cap provided. Remove white cap and dispose of funnel in the appropriate manner.
4. Label centrifuge tube – place into the container and replace white cap.
5. Forward to the lab.

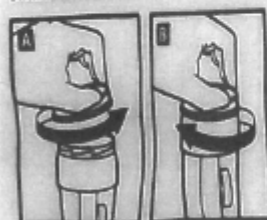

**Patient Instructions:**

- A. For collection, do not remove outer plastic label. Unscrew white cap and expectorate into funnel.
- B. After specimen is collected, replace white cap by screwing tightly on container.

Unit	Par Location ID	Item	Optim Qty
IPMC1	PAR_2CENTERORTH	000000000000034225	5.0000
IPMC1	PAR_2NORTHMED	000000000000034225	5.0000
IPMC1	PAR_3NORTHMED	000000000000034225	5.0000
IPMC1	PAR_5ICU	000000000000034225	5.0000
IPMC1	PAR_5NORTHMED	000000000000034225	5.0000
IPMC1	PAR_5SOUTHTELEM	000000000000034225	5.0000
IPMC1	PAR_GEMERGENC	000000000000034225	5.0000





Current Kit PS 225244  
Cardinal #001-8000C  
0.63 each  
Stocked @ Phelps SIBU

Usage 53,100.00 kits / year  
Current Spend \$33,500.00  
New Product Spend \$65,844

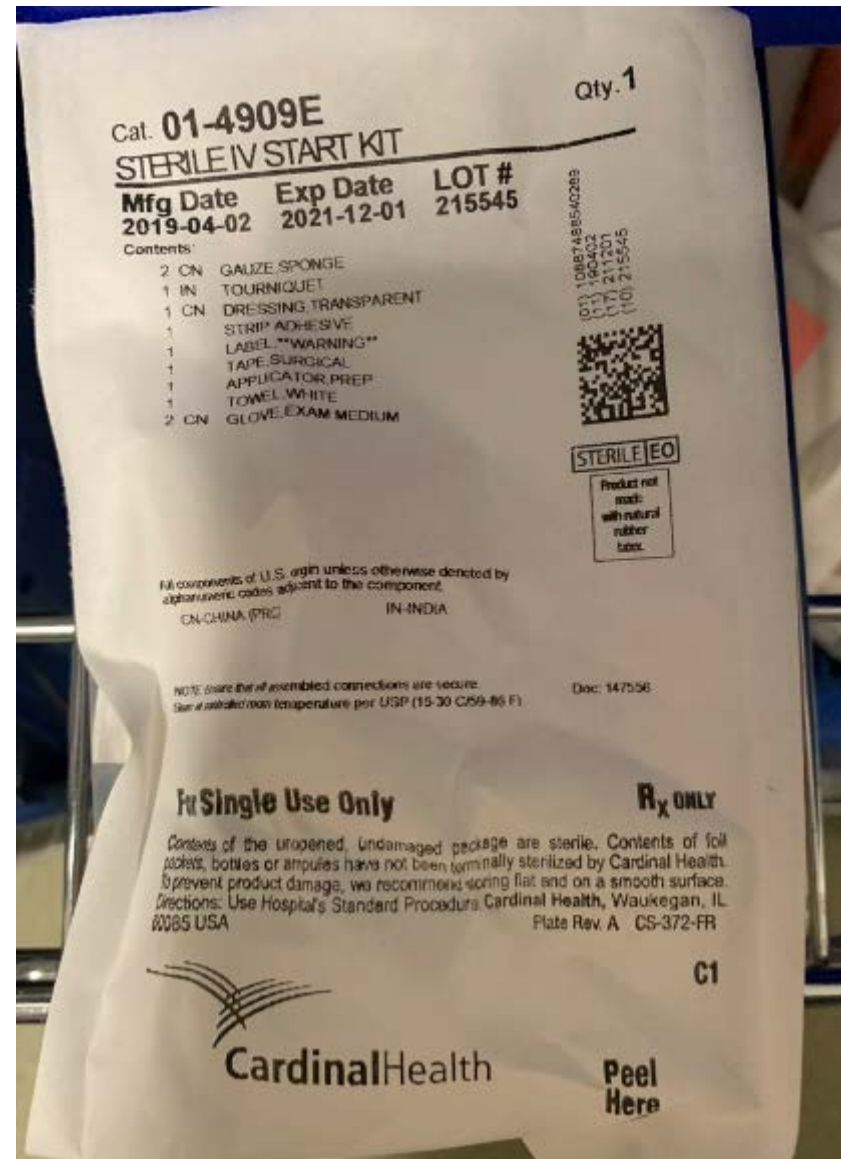

Proposed Kit PS 105870  
Cardinal 01-4909E  
\$1.24 each  
Stocked @ Northwell IDC

Sterile Kit  
Applicator Prep / One Step  
White Towel  
Exam Gloves

# Thank You!



Questions?

Comments?

Suggestions?