

8572

TORQUE WRENCH DREMOMETER

1500-3000Nm

Use:

- For use in almost all industrial manufacturing areas.
- For controlled nut and bolt tightening.

Features:

- Adjustable torque wrench with a 1.1/2" single square drive for controlled clockwise tightening.
- 1.1/2" square drive with ball-locking mechanism as per DIN 3120.
- In accordance with DIN EN ISO 6789, traceable to national norms.
- Automatic short path actuation with tactile impulse and audible signal.
- Actuation accuracy: +/- 3% tolerance of the scale set to torque.
- Full-metal construction from high strength aluminium alloy.
- Double scale with scale graduation of 50Nm.
- Extension tube with maximum lever length of 2343mm.
- Supplied with a calibration certificate.
- Unique serial number for traceability.

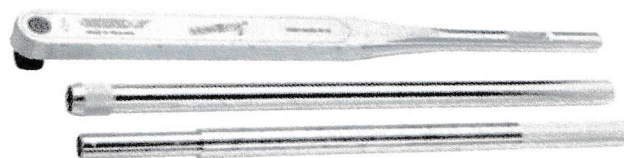

| Code | Type | No. | □" | ■ | Contents | | Nm | lbf-in | mm | |
|---------|------|---------|-------|----|------------------------|------|-----------|--------|-----------|-------|
| 7717160 | | 8572-01 | 1.1/2 | 40 | with 2 extension tubes | 50Nm | 1500-3000 | | 1423-2343 | 13.20 |

753

TORQUE WRENCH DREMOMETER MINI

2-12Nm

Use:

- For use in almost all industrial manufacturing areas.
- For controlled nut and bolt tightening.

Features:

- Adjustable torque wrench with a 1/4" single square drive for controlled clockwise tightening.
- 1/4" square drive with ball-locking mechanism as per DIN 3120.
- In accordance with DIN EN ISO 6789, traceable to national norms.
- Automatic short path actuation with tactile impulse and audible signal.
- Actuation accuracy: +/- 3% tolerance of the scale set to torque.
- Window with a magnifying-glass effect.
- Double scale with a scale graduation of 0.5Nm and 5 lbf-in.
- Additional micrometer scale for setting interim values with Nm, graduations of 0.05Nm
- Supplied with a calibration certificate.
- Unique serial number for traceability.



| Code | Type | No. | □" | ■ | Contents | | Nm | lbf-in | mm | |
|---------|------|--------|-----|-----|----------------|-------------------------|------|--------|-----|-------|
| 1957694 | Mini | 753-11 | 1/4 | 6.3 | in plastic box | 0,5Nm / lbf-in + 0,05Nm | 2-12 | 18-106 | 211 | 0.320 |

8200

TORQUE ANGLE INDICATOR

Use:

- Additional angle regulated tightening for controlled torque and angle activation.

Features:

- For additional precise angle tightening (0 - 360°)
- 1/2" square drive with ball-locking device.
- With sliding magnetic and gripping arm.
- For use with a suitable torque wrench.
- The maximum output of the torque wrench must not be exceeded.

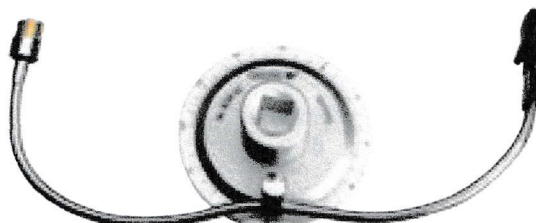

| Code | No. | □" | □" | mm | ° | |
|---------|---------|-----|-----|----|-------|-------|
| 1195980 | 8200-01 | 1/2 | 1/2 | 80 | 0-360 | 0.330 |

TSN SLIPPER



Pre-set ratchet head torque wrench with automatic actuation and slip function. Over-tightening is not possible.



Working principle

TSN SLIPPER

When the pre-set torque value is achieved, the mechanism slips through over the ball (without the possibility of over-tightening). The torque wrench is then immediately ready for the next operation.

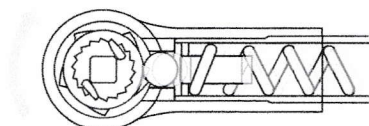

Technical information

TSN SLIPPER & TBN BREAKER

All TSN Slipper and TBN Breaker torque wrenches (apart from 760-00/-01) are fitted with the patented Mechanical Torque Adjustment Locking Device to modify torque tester.

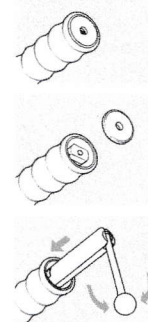

759

TORQUE WRENCH TSN SLIPPER

3-125Nm / pre-set



Use:

- For use in all areas of production line assembly.
- For controlled nut and bolt tightening.

Features:

- Pre-set production torque wrench without scale.
- Square drive with ball-locking mechanism.
- Integrated ratchet function for bi-directional tightening.
- In accordance with DIN EN ISO 6789, traceable to national norms.

- Actuation accuracy: $\pm 4\%$ tolerance of the set torque.
- Precision mechanism slides through very noticeably and audibly when the pre-set torque is achieved – over tightening is not possible.
- Automatic resetting to the starting position.
- Lightweight yet stable and corrosion resistant construction design.
- Black, non-slip rubber handgrip.
- Supplied with a calibration certificate.
- Unique serial number for traceability.

| Code | No. | 1/4" | 3/8" | Nm | 1/2" | 1/4" |
|---------|--------|------|------|--------|------|-------|
| 7091900 | 759-00 | 1/4 | 6.3 | 5-25 | 216 | 0.340 |
| 7092040 | 759-01 | 1/4 | 6.3 | 5-25 | 216 | 0.340 |
| 7092120 | 759-02 | 3/8 | 10.0 | 15-55 | 324 | 0.800 |
| 7092200 | 759-03 | 1/2 | 12.5 | 40-125 | 460 | 1.360 |

761

TORQUE WRENCH TSP SLIPPER

1-10Nm / pre-set

**Use:**

- For use in all areas of assembly work where controlled tightening with low torque values is required (eg electronic hardware sector).
- For controlled nut and bolt tightening.

Features:

- Pre-set production torque wrench without scale.
- Square drive with ball-locking mechanism.
- Integrated ratchet function for bi-directional tightening.
- In accordance with DIN EN ISO 6789, traceable to national norms.

- Actuation accuracy: $\pm 6\%$ tolerance of the set torque.
- Precision mechanism slides through very noticeably and audibly when the pre-set torque is achieved – over tightening is not possible.
- Automatic resetting to the starting position.
- Lightweight yet stable and corrosion resistant construction design.
- ESD (electrostatic discharge) = electrostatically protected.
- Black, non-slip rubber handgrip.
- Supplied with a calibration certificate.
- Unique serial number for traceability.

| Code | No. | 1/4" | 6.3 | Nm | 185 | 0.190 |
|---------|--------|------|-----|------|-----|-------|
| 1196650 | 761-05 | 1/4 | 6.3 | 1-5 | 185 | 0.190 |
| 1196731 | 761-10 | 1/4 | 6.3 | 2-10 | 185 | 0.190 |

762

TORQUE WRENCH TSC SLIPPER

1-10Nm

**Use:**

- For use in all areas of assembly work where controlled tightening with low torque values is required (eg electronic hardware sector).
- For controlled nut and bolt tightening.

Features:

- Square drive with ball-locking mechanism.
- Integrated ratchet function for bi-directional tightening.
- In accordance with DIN EN ISO 6789, traceable to national norms.
- Actuation accuracy: $\pm 6\%$ tolerance of the set torque.

- Precision mechanism slides through very noticeably and audibly when the pre-set torque is achieved – over tightening is not possible.
- Automatic resetting to the starting position.
- Lightweight yet stable and corrosion resistant construction design.
- ESD (electrostatic discharge) = electrostatically protected.
- Black, non-slip rubber handgrip.
- Supplied with a calibration certificate.
- Unique serial number for traceability.

| Code | No. | 1/4" | 6.3 | Nm | 195 | 0.235 |
|---------|--------|------|-----|------|-----|-------|
| 1196480 | 762-05 | 1/4 | 6.3 | 1-5 | 195 | 0.235 |
| 1196510 | 761-10 | 1/4 | 6.3 | 2-10 | 195 | 0.235 |

TSC

TORQUE WRENCH ADJUSTABLE SLIPPER

10-90Nm

**Use:**

- For use in all areas of assembly work where controlled tightening with low torque values is required (eg electronic hardware sector).
- For controlled nut and bolt tightening.

Features:

- Improved control of the fastening process by reducing the risk of both under and over tightening.
- Unique slipping mechanism, which gives the operator more time to react once the target torque is reached.
- Actuation accuracy: $\pm 6\%$ tolerance of the set torque.

- Maintains production output by minimising operator fatigue through the tool's ergonomic design.
- Maximises productivity in restricted space through its compact slimline design.
- EPA compliant for use in electrostatically sensitive applications.
- Drive type made of stainless steel.
- Supplied with a calibration certificate.
- Unique serial number for traceability.
- Accessories available.

| Code | No. | 1/4" | 6.3 | Nm | 195 | 0.235 |
|--------|--------|------|-----|-------|-----|-------|
| 056060 | TSC-45 | 1/4 | 6.3 | 10-45 | 195 | 0.235 |
| 056080 | TSC-90 | 1/4 | 6.3 | 20-90 | 195 | 0.235 |

TBN BREAKER



Pre-set torque wrench with automatic snap actuation. Torque wrench offering maximum accuracy. Guaranteed tightening values without over-tightening.

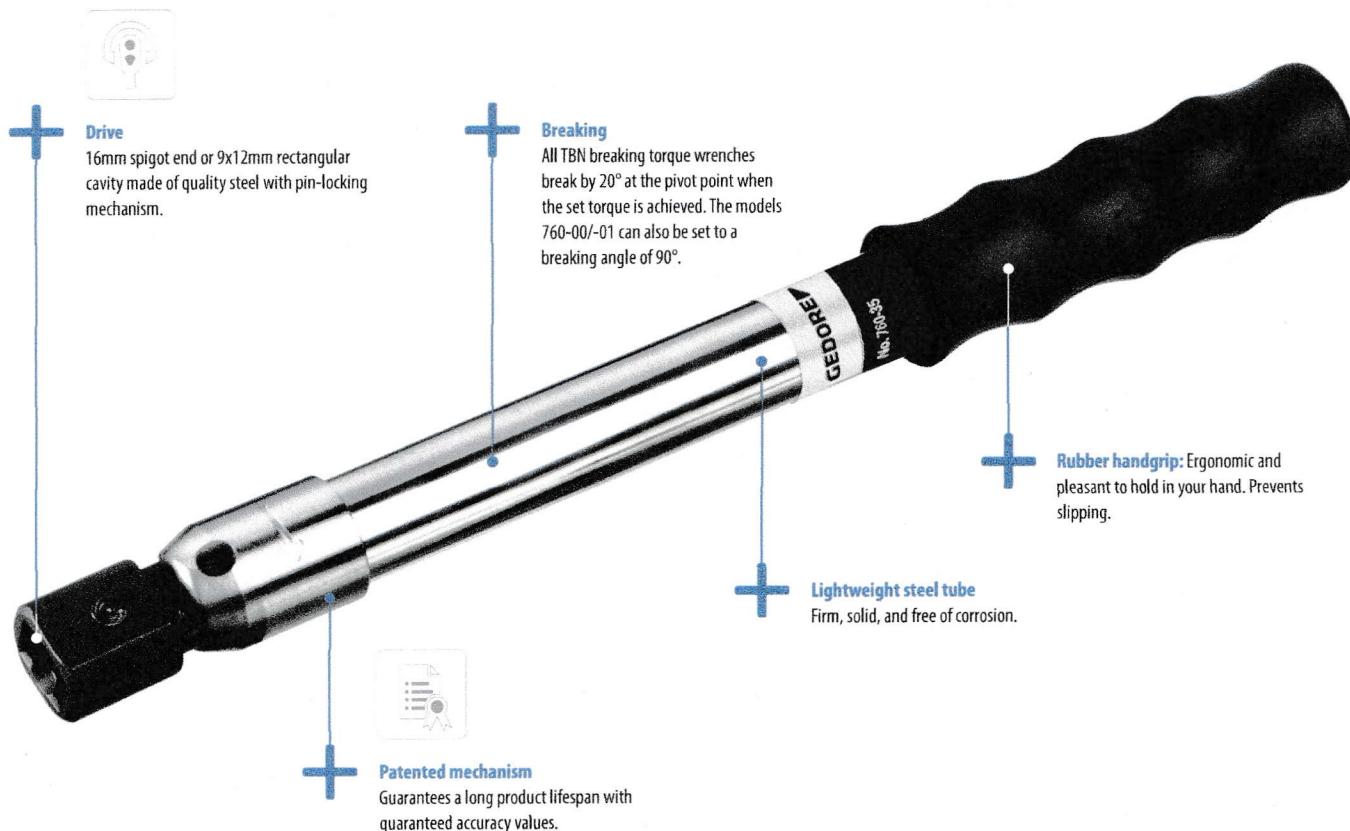

TBN Knicker
⑮
5 - 135Nm



TBN Knicker
⑮x12
0,2 - 135Nm



As an option, Gedore also manufactures the TBN Breaker models 760-00/-01 with interchangeable fittings directly positioned on the tool.

Working principle

TBN BREAKER

When the TBN breaking torque wrench is operated, the rear section of the driver unit presses the roller. When the pre-set torque value is achieved, the lever switches over and the front section of the drive unit breaks.

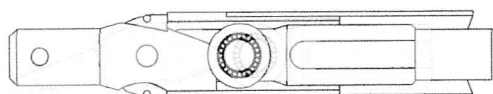

Technical information

TBN BREAKER

TBN Breaker 760-00/-01 values are changed using the Double Positive adjustment system.



760

BREAKING TORQUE WRENCH TBN

0,4-200Nm / 44-147lbf·in / pre-set

16

9x12







Use:

- For controlled nut and bolt tightening.
- For use in all areas of production line assembly.
- Extremely durable.

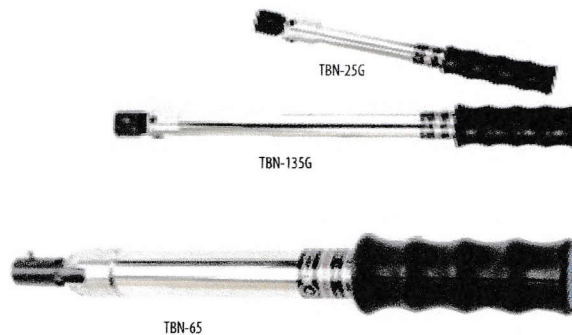
Features:

- Pre-set production torque wrench – without scale
- With 9x12mm rectangular cavity end or 16mm spigot-end.
- For bi-directional tightening (the wrench only has to be turned by 180°).
- Actuation accuracy: +/- 4% tolerance of the set torque.
- Precision mechanism slides through very noticeably and audibly when the pre-set torque is achieved – over tightening is not possible.
- Automatic resetting to the starting position.
- Lightweight yet stable and corrosion resistant construction design.
- Black, non-slip rubber handgrip.
- No. 760-00/-01: EPA (Electrostatic Protected Area) compliant.
- The TBN range is available with a variety of end fitting styles.



| Code | No. | Ø |  | EPA | Nm | lbf-in |  |  |
|---------|----------|----|---|-----|--------|----------|---|---|
| 7090690 | TBN-2G | | 9x12 | x | 0.4-2 | 1.8-18 | 133 | 0.125 |
| 7090770 | TBN-10G | | 9x12 | x | 1-10 | 9-89 | 133 | 0.145 |
| 1824694 | TBN-25G | | 9x12 | | 5-25 | 44-221 | 265 | 0.405 |
| 1824716 | TBN-65G | | 9x12 | | 10-65 | 89-575 | 302 | 0.745 |
| 1824732 | TBN-135G | | 9x12 | | 25-135 | 177-1195 | 408 | 1.03 |
| 050310 | TBN-200G | | 14x18 | | 40-200 | | 520 | 1.40 |
| | | | | | | | | |
| 1825686 | TBN-25 | 16 | | | 5-25 | 44-221 | 265 | 0.410 |
| 1824708 | TBN-65 | 16 | | | 10-65 | 89-575 | 302 | 0.750 |
| 1824724 | TBN-135 | 16 | | | 20-135 | 177-1195 | 408 | 1.03 |
| 050300 | TBN-200 | 16 | | | 40-200 | | 520 | 1.40 |

ATB SE

ADJUSTABLE BREAKING TORQUE WRENCH

1-10Nm

9x12



Use:

- Controlled bolt and nut tightening.
- For use in all areas of production line assembly.
- Extremely durable.

Features:

- Compact design allows easy access where space is restricted.
- With 9x12 mm rectangular end.
- Offers improved control of the tightening process by reducing the risk of under and over tightening. This is achieved by Torqueleader's unique breaking mechanism that allows the operator more time to react once the target torque is achieved.
- Accuracy +/- 6% of reading.
- Reduces the likelihood of warranty and rework by assuring process control through accurate and repeatable torque application.
- Automatic resetting to the starting position.
- Fast and accurate to set using the quick and clear to read micrometer setting scale.
- Black, non-slip rubber handgrip.
- This tool is length dependent, with hand position altering the torque applied.
- Accessories available.



| Code | No. | mm | ISO | mm | kg |
|---------|---------|------|------|-----|-------|
| 2839636 | ATB-5G | 9x12 | 1-5 | 230 | 0.290 |
| 2839644 | ATB-10G | 9x12 | 2-10 | 230 | 0.300 |

Torque wrench Type 88

8801 TORQUE WRENCH

150-1500Nm

Use:

- › Controlled bolt and nut tightening in the range 100 - 1500Nm.
- › For use in all areas of industry, automotive sector and machine maintenance.

Features:

- › Adjustable torque wrench with scale.
- › 3/4" square drive with integrated ratchet function.
- › Push-through square drive for bi-directional tightening.
- › In accordance with DIN EN ISO 6789, traceable to national norms.

- › Breaker mechanism (handle snaps over) is seen and felt when selected torque is reached, reducing the likelihood of over tightening.
- › Dual scale in Nm and lbf-ft
- › Actuation accuracy: +/- 4% tolerance of the value setting.
- › 4 models in the range 150 - 1500Nm
- › Robust construction.
- › Supplied with a calibration certificate and unique serial number for traceability.
- › Delivered in sturdy cardboard packaging

3/4"



± 4%
Accuracy

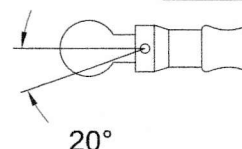

| Code | Code | 3/4" | 20 | 10Nm | Nm | 1090 | 5.50 |
|---------|---------|------|----|------|----------|------|-------|
| 3022854 | 8801-01 | 3/4 | 20 | 10Nm | 150-700 | 915 | 5.50 |
| 3022862 | 8801-02 | 3/4 | 20 | 10Nm | 200-800 | 1090 | 6.00 |
| 3022870 | 8801-03 | 3/4 | 20 | 20Nm | 300-1000 | 1470 | 7.30 |
| 3022889 | 8801-04 | 3/4 | 20 | 25Nm | 700-1500 | 1470 | 10.00 |

Torcotronic 3

TT3KH ELECTRONIC TORQUE WRENCH TORCOTRONIC III

70-350Nm / 51.6-258.2lbf-ft

1/2"

± 1%
Accuracy



Use:

- › For everyday requirements in installation and torque control.
- › For use in all areas of manufacturing and development.

Features:

- › Microprocessor controlled, electronic torque wrench with CE symbol.
- › For controlled bi-directional tightening
- › Broad measurement range in Nm, can be switched to lbf-ft.
- › With 1/2" reversible ratchet. The ratchet is exchangeable, providing the option of using a 9x12mm (8455-120) or 14x18mm (8455-350) square socket.

Characteristics:

- › Torque and torque angle measure.
- › 5 different measuring modes.
- › 5 parameters storable.
- › USB interface for data exchange.
- › 2000 storage places
- › High measurement accuracy: +/-1% tolerance for all read-off values, +/-1 digit.
- › Different depth gauges for end fittings programmable.
- › Simple to operate with easy to understand icon-menu navigation and 4 functional keys.
- › Clearly readable, illuminated LCD display.

- › Resolution torque: 0.1Nm.
- › Resolution torque angle: 0.1°.
- › PC-software easy to operate for uncomplicated programming and documentation of data.
- › Data can be transferred to MS Excel®.
- › Keyboard lock.
- › Operation with standard Mignon AA or optional with rechargeable-battery (NiMH).
- › Visual signal: 3x LED (yellow, green, red).
- › Acoustic signal: buzzer.

Scope of delivery:

- › Electronic torque wrench TorcoTronic III HighLine.
- › Reversible ratchet 1/2".
- › USB cable.
- › Software on CD-R.
- › Supplied with a calibration certificate.
- › Delivered in a transparent plastic box with insert.

Attention:

- › A PC, running Windows® operating system (from Windows XP®) is required to obtain the full benefit of all the functions of this product.

| Code | Code | 1/2" | 12.5 | 14x18 | N-m | lbf-ft | 1.20 |
|---------|-----------|------|------|-------|------------|--------|------|
| 2648644 | TT3KH-350 | 1/2 | 12.5 | 14x18 | 51.6-258.2 | 70-350 | 1.20 |

TORQUE WRENCHES WITH SLAVE POINTER IDEAL FOR TEST, CONTROL AND MAINTENANCE WORK

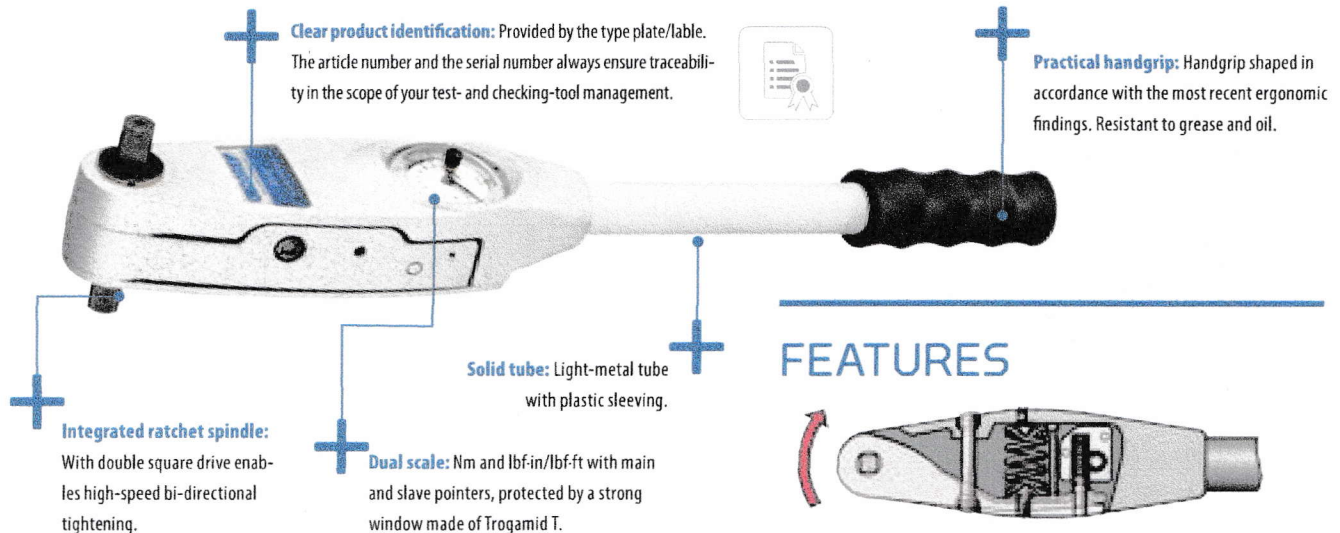

FEATURES

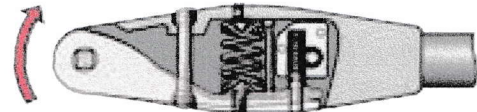

The working principle of the torque wrench with slave pointer type 83

8301 - 8302

TORQUE WRENCH WITH SLAVE POINTER

0.8-200Nm

1/4" 3/8" 1/2"

±4%
Accuracy



Use:

- Controlled tightening and verification of tightening values.
- For use in all areas of industrial manufacturing and quality control.
- Working ranges of 0.8 to 200Nm are covered.

Features:

- Dial-indicating torque wrench with dual scale and multi-functional slave pointer.
- 1/4", 3/8", 1/2" double-square drive with ball locking device for controlled bi-directional tightening.
- Models 8301-04 to 8302-20: With integrated ratchet function.
- For controlled screw tightening and torque measurements.
- Working accuracy: +/- 4% tolerance of the indicated torque.
- Double scale in Nm and lbf-in or lbf-ft double tinted clearly readable face.
- Integrated overload protection – mechanical stop up to maximum 25% overload of the maximum value.
- Housing made of lightweight, robust special aluminium construction – lacquered, silver-grey.
- Black, non-slip rubber handgrips.
- Models 8301-04 to 8301-40: EPA-conformant (Electrostatic Protected Area), for use in sensitive electrostatic applications.

Scope of delivery:

- Dial-measuring torque wrench type 83.
- Test certificate according to DIN EN ISO 6789.
- Delivered in a sturdy black plastic box (no. 8301-04 to 8302-20).

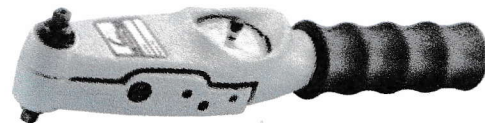

8301

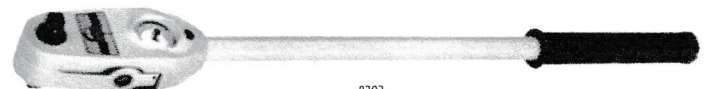

8302

| Code | Code | Type | 1/4" | 3/8" | 1/2" | Nm | lbf-in | Height | l-mm | EPA | Weight |
|---------|---------|------|------|------|-----------------|--------|--------|--------|------|-----|--------|
| 7651390 | 8301-04 | ↔ | 1/4 | 6.3 | 0,1Nm / 1lbf-in | 0,8-4 | 7-35 | 61 | 244 | x | 0,50 |
| 7651470 | 8301-12 | ↔ | 1/4 | 6.3 | 0,5Nm / 2lbf-in | 2,4-12 | 21-105 | 61 | 244 | x | 0,50 |
| 7651550 | 8301-25 | ↔ | 3/8 | 10.0 | 1Nm / 10lbf-in | 5-25 | 44-240 | 69 | 244 | x | 0,50 |
| 7651630 | 8301-40 | ↔ | 3/8 | 10.0 | 1Nm / 10lbf-in | 8-40 | 72-360 | 69 | 244 | x | 0,50 |
| 7651710 | 8302-08 | ↔ | 1/2 | 12.5 | 2Nm / 1lbf-ft | 16-80 | 12-60 | 86 | 435 | | 1.40 |
| 7651980 | 8302-20 | ↔ | 1/2 | 12.5 | 5Nm / 5lbf-ft | 40-200 | 30-160 | 86 | 435 | | 1.40 |

TORQUE SCREWDRIVERS 756

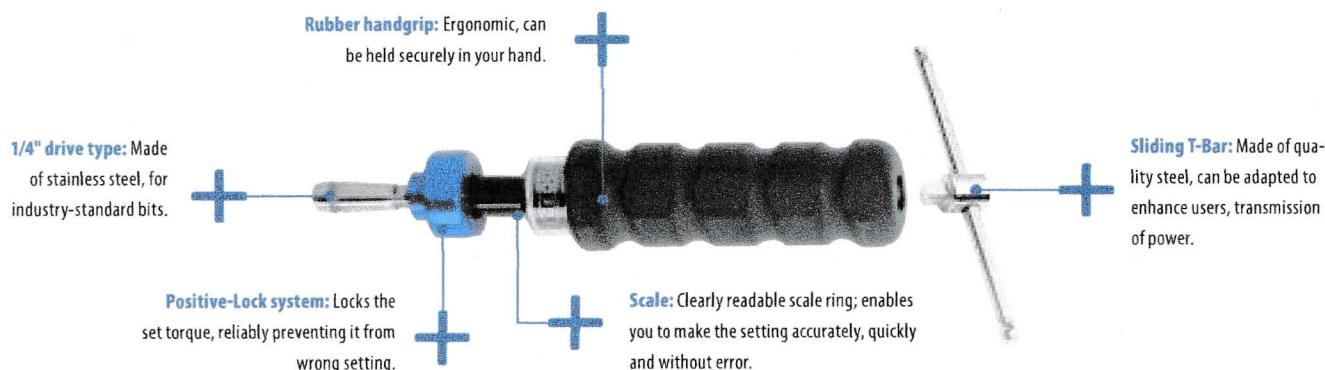

756 TORQUE SCREWDRIVER TYPE S

0.24-9Nm

Use:

- For controlled screw tightening.
- For use in electrical hardware, industrial manufacturing or in quality control.

Features:

- Adjustable torque screwdriver – with scale.
- With 1/4" female hexagon drive for use with 1/4" hexagon bits.
- Actuation accuracy: $\pm 6\%$ tolerance of the set torque.
- In accordance with DIN EN ISO 6789, traceable to national norms.
- Precision radial ball clutch and cam design for controlled bi-directional tightening
- Precision mechanism slips through very noticeably when the pre-set torque is achieved.
- Automatic resetting to the starting position.
- With set-torque-locking 'positive-lock' system, automatically fixes the set torque.
- Non-slip rubber handgrip.
- Micrometer scaling: 1cNm and 0.1Nm.

- EPA-conformant (Electrostatic Protected Area), for use in sensitive electrostatic applications

Scope of delivery:

- Torque wrench type 756.
- 1/4" square/hexagon drive adapter (no. 757-20).
- Models 756-06/-09 with additional sliding T-bar for ease of use.
- Supplied with a calibration certificate.
- Unique serial number for traceability.



| Code | Code | 1/4" | 3/8" | 1/2" | 3/4" | 1" | Nm | cNm | Height | L (mm) | Weight (kg) |
|---------|--------|------|------|------|------|-------|----------|---------|--------|--------|-------------|
| 1400150 | 756-01 | 1/4 | 6.3 | 1/4 | 6.3 | 1cNm | 0.24-1.2 | 20-120 | 61 | 183 | 0.165 |
| 1400169 | 756-06 | 1/4 | 6.3 | 1/4 | 6.3 | 0.1Nm | 1-6 | 120-600 | 61 | 196 | 0.340 |
| 1400177 | 756-09 | 1/4 | 6.3 | 1/4 | 6.3 | 0.1Nm | 4-9 | 400-900 | 69 | 196 | 0.340 |

TLS PRO PRESET TORQUE SCREWDRIVER

0.05-13.5Nm

- Accurate process control is ensured by eliminating under and over tightening due to Torqueleader's proven slipping technology.
- Years of dependable service is provided by the robust design especially if regularly calibrated.
- Calibration stickers can be easily applied to the purpose designed nose.
- To allow for customisation and clear identification, interchangeable coloured end caps are available.
- Increased production efficiency by reducing operator fatigue due to a specifically designed ergonomic handgrip combined with a smooth tool reset action.
- To assist with higher torque, T-bars come standard with the Pro and ESD 450 and 1350 models.



| Code | Code | 1/4" | 3/8" | Nm | cNm | L (mm) | Weight (kg) |
|--------|---------------|------|------|-----------|----------|--------|-------------|
| 065400 | TLS PRO 25H | 1/4 | 6.3 | 0.05-0.25 | 5-25 | 132 | 0.210 |
| 065500 | TLS PRO 150H | 1/4 | 6.3 | 0.2-1.5 | 20-150 | 132 | 0.210 |
| 065600 | TLS PRO 450H | 1/4 | 6.3 | 0.5-4.5 | 50-450 | 140 | 0.230 |
| 065700 | TLS PRO 1350H | 1/4 | 6.3 | 2.5-13.5 | 250-1350 | 140 | 0.230 |

8612

ELECTRONIC TORQUE TESTER DREMOTEST E

0.9-3150Nm

1/4" 1/4" 3/8" 1/2" 1"

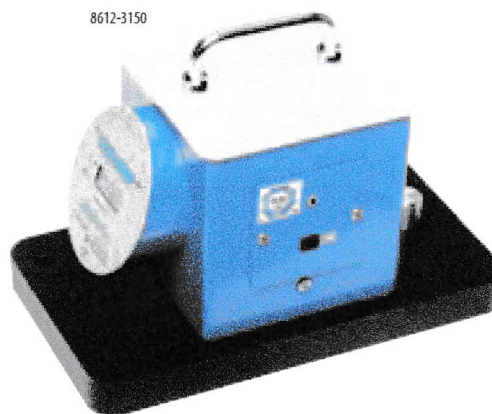

8612-720 – 8612-740

- Guaranteed measuring accuracy: $\pm 2\%$ of read-out in the core range of 20-100% of the scale.
- Double scale in cNm and ozf.in or Nm and lbf.in.
- For testing and setting clockwise torque wrenches and screwdrivers in the lower torque range of 0-25Nm.

8612-050 – 8612-3150

Use:

- For verifying and setting clockwise torque wrenches and torque screwdrivers.

Features:

- Simple, electronic torque tester with integrated torque transducer (DMS).
- 4 models in the range from 0.9 to 3150Nm.
- Model 8612-3150 with 10mm, 17mm and 36mm hexagonal socket (size dependent).
- Model 8612-3150 with 1" square drive adapter.
- Models 8612-050 - 8612-1000 with 1/4", 3/8" or 1/2" square drive adapter (depending on the size).
- High measurement accuracy: $\pm 1\%$ tolerance of reading, ± 1 digit.
- Break-point measurement (1st peak).
- Auto reset.
- Can be switched from Nm to lbf.ft.
- Serial RS232 interface.

Scope of delivery:

- Electronic torque tester.
- RS232 cable.
- Power supply unit.
- 100 - 240 V, 50 - 60 Hz, maximum 500mA (see type plate).
- 2 sockets (size and drive model-dependent).
- Adapter for 8612-3150.
- Operating instructions.

| Code | No. | Hex | Hex" | Hex" | Resolution | Adapter | lbf.ft | Nm | cNm/Nm | ozf.in/lbf.in | Gradation | Accuracy |
|---------|-----------|-----|------|----------|------------|----------|----------|----------|--------|---------------|---------------|----------|
| 1824635 | 8612-720 | | 1/4 | 1/4 | | | | | 26-130 | 36-180 | 2cNm/2ozf.in | 10.0 |
| 1824651 | 8612-740 | | | 1/4, 3/8 | | | | | 2.4-12 | 0.2-2 | 0.2Nm/2lbf.in | 3.2 |
| 1947699 | 8612-050 | 10 | | | 0.01 | 1/4, 3/8 | 0.7-40.6 | 0.9-55 | | | | 3.0 |
| 1856111 | 8612-300 | 17 | | | 0.1 | 3/8, 1/2 | 7-236 | 90-320 | | | | 3.0 |
| 1947702 | 8612-1000 | 36 | | | 1 | 1/2, 3/4 | 66-811 | 90-1100 | | | | 10.0 |
| 2529858 | 8612-3150 | | | | 1 | 1 | 369-2323 | 500-3150 | | | | 26.0 |

1425/41/D19

>134

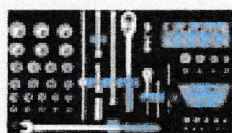

502 MOTORIST TOOLKIT

>113

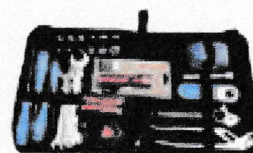

CAPTURE SYSTEM

A NEW STANDARD IN TORQUE ANALYSER SYSTEMS:

Highly accurate measurement of hand and power torque tools, the System has been designed and tested in conjunction with the National Physical Laboratory in the UK, a world leader in electronic measurement systems.

Designed to allow users to become productive quickly, as the System is quick to set up and requires little training due to the System's intuitive easy to use menus and Plug & Play connectivity.

The Capture System maximises torque tool test efficiency as the Display, Sensor and Manager PC software have been designed to work together, automating many functions.

Versatile design allows static laboratory use and mobile data collection using an onboard memory and rechargeable battery. The data can then be transferred to PC via a USB connection.



CAPTURE MANAGER PC SOFTWARE

KEY BENEFITS OF CAPTURE MANAGER

PC software – effectively manage your data:

- Manage tool and test data through the Capture Manager PC software.
The software also makes analysing the data quick and easy through integration with Microsoft Excel.
- The Capture Manager PC software allows unlimited storage of tools and data readings which can be uploaded and downloaded to the Capture Display via a USB connection.
- Ensures tools are performing to the required standard through the ISO 6789:2003 test wizard.
This clear and easy to use feature guides the user through the test procedure.
- Tool traceability can be achieved as the Capture Manager PC software can generate customised calibration certificates to the requirements of ISO 6789:2003.

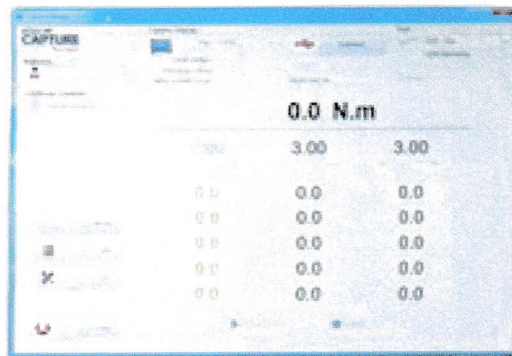

CAPTURE DISPLAY

KEY BENEFITS OF CAPTURE DISPLAY

Intuitive - easy to use:

- › Designed to allow users to become productive quickly due to its intuitive features, such as easy to navigate menus, tool database and Plug & Play integration with Capture Sensors.
- › Versatile design allows static laboratory use and mobile data collection using an onboard memory and rechargeable battery. The data can then be transferred to PC via a USB connection.
- › Minimise investment, as the Capture Display is designed to integrate with customers' existing industry standard nominal 2mV/V transducers.
- › To protect the Capture Display when not in use, it is supplied complete in a high-impact plastic carry-case. In addition, the following items are included with the display and are stored in the case: USB power cable (for charging from mains or PC and also used for data transfer), power supply (multi-national), calibration certificate, start up guide and instructions.
- › Work for longer between battery charges as the unit is fitted with a long-life Lithium-ion battery and has an auto power down mode.

Technical information:

- › Capture Display can store 500 tools and 2000 data readings in the onboard memory.



| Code | Code |
|--------|-----------------|
| 036700 | Capture display |

CAPTURE SENSOR



KEY BENEFITS OF CAPTURE SENSOR

- › Built-in flexibility as the sensor can be mounted horizontally or vertically without the need for any accessories.
- › Fast to set up when used with a Capture Display due to the imbedded Quicktec technology which passes all the Sensor information to the Display.
- › Remove human error from testing by using the Capture Sensor with the ISO 1500/90 Torque Loading System (adaptor required).
- › To protect the Sensor when not in use it is supplied in a high-impact plastic carry-case.
- › Easy to repair due to a modular design that allows for simple component replacement.
- › For users with limited space who need to change Sensors between tests the Quick Change Plate increases calibration productivity.

Technical information:

- › Sensors come complete with UKAS certificate to BS 7882:2008 Class 1 or better.
- › Calibrated range is 10% to 100% of capacity.
- › Ranges covered 0.2-1500Nm.



| Code | No. | Mounting hole size | Nm | Hole centres | ■" | H x W x D | kg |
|--------|---------|---------------------------|---------|--------------|-----|-----------------|-------|
| 036805 | CS-2 | M8 x 1.25 (10 Deep Min.) | 0.2-2 | 56mm | 1/4 | 62 x 85 x 65 | 0.500 |
| 036810 | CS-10 | M8 x 1.25 (10 Deep Min.) | 1-10 | 56mm | 1/4 | 62 x 85 x 65 | 0.500 |
| 036820 | CS-50 | M8 x 1.25 (10 Deep Min.) | 5-50 | 56mm | 3/8 | 62 x 85 x 65 | 0.570 |
| 036830 | CS-250 | M12 x 1.75 (16 Deep Min.) | 25-250 | 79mm | 1/2 | 82 x 120 x 87 | 1.45 |
| 036845 | CS-1500 | M16 x 2.00 (20 Deep Min.) | 15-1500 | 125mm | 1 | 100 x 165 x 134 | 4.00 |

| Code | Model |
|--------|---|
| 036226 | Capture Cable - CAPTURE to CUSTOM Sensor |
| 036246 | Capture Cable - CAPTURE to CAPTURE Sensor |
| 036771 | CAPTURE Sensor ISO 1500/90 Adapter |
| D18205 | CAPTURE Sensor ISO-A Mount |
| 036772 | CAPTURE Sensor Quick Change Plate |

End fittings 9x12 / 14x18 SE

7112 / 7118

RECTANGULAR OPEN END FITTING

9x12-14x18

- › For accessing bolts in cramped and hard-to-reach locations, easy to change.
- › Forged.
- › Chrome Vanadium steel, matt chrome plated.
- › With eject-pin for unlocking.



| Code | No. | mm | mm | mm | mm | Depth gauge | |
|---------|---------|----|--------|-----|------|-------------|-------|
| 7688390 | 7112-07 | 7 | 9 x 12 | 5.5 | 20.0 | 17.5 | 0.035 |
| 7688550 | 7112-08 | 8 | 9 x 12 | 5.5 | 21.5 | 17.5 | 0.035 |
| 7679050 | 7112-09 | 9 | 9 x 12 | 5.5 | 23.0 | 17.5 | 0.035 |
| 7688630 | 7112-10 | 10 | 9 x 12 | 5.5 | 24.5 | 17.5 | 0.040 |
| 7688980 | 7112-11 | 11 | 9 x 12 | 5.5 | 26.0 | 17.5 | 0.030 |
| 7679560 | 7112-12 | 12 | 9 x 12 | 5.5 | 27.5 | 17.5 | 0.035 |
| 7689010 | 7112-13 | 13 | 9 x 12 | 5.5 | 29.0 | 17.5 | 0.035 |
| 7689360 | 7112-14 | 14 | 9 x 12 | 7.5 | 31.0 | 20.0 | 0.040 |
| 7689440 | 7112-15 | 15 | 9 x 12 | 7.5 | 33.0 | 20.0 | 0.040 |
| 7679990 | 7112-16 | 16 | 9 x 12 | 7.5 | 35.0 | 20.0 | 0.045 |
| 7689600 | 7112-17 | 17 | 9 x 12 | 7.5 | 37.0 | 20.0 | 0.050 |
| 7684560 | 7112-18 | 18 | 9 x 12 | 7.5 | 39.0 | 20.0 | 0.060 |
| 7689790 | 7112-19 | 19 | 9 x 12 | 7.5 | 41.0 | 20.0 | 0.060 |

| Code | No. | mm | mm | mm | mm | Depth gauge | |
|---------|---------|----|---------|----|------|-------------|-------|
| 7689870 | 7118-13 | 13 | 14 x 18 | 7 | 30.0 | 25.0 | 0.120 |
| 7690020 | 7118-14 | 14 | 14 x 18 | 7 | 32.0 | 25.0 | 0.120 |
| 7690100 | 7118-15 | 15 | 14 x 18 | 7 | 34.0 | 25.0 | 0.120 |
| 7685610 | 7118-16 | 16 | 14 x 18 | 9 | 35.5 | 25.0 | 0.130 |
| 7690370 | 7118-17 | 17 | 14 x 18 | 9 | 37.0 | 25.0 | 0.130 |
| 7686180 | 7118-18 | 18 | 14 x 18 | 9 | 39.0 | 25.0 | 0.130 |
| 7690450 | 7118-19 | 19 | 14 x 18 | 9 | 41.0 | 25.0 | 0.130 |
| 7686420 | 7118-21 | 21 | 14 x 18 | 11 | 45.0 | 25.0 | 0.155 |
| 7690610 | 7118-22 | 22 | 14 x 18 | 11 | 47.0 | 25.0 | 0.150 |
| 7690880 | 7118-24 | 24 | 14 x 18 | 11 | 51.0 | 25.0 | 0.170 |
| 7690960 | 7118-27 | 27 | 14 x 18 | 13 | 58.5 | 32.5 | 0.185 |
| 7691260 | 7118-30 | 30 | 14 x 18 | 13 | 67.5 | 32.5 | 0.220 |
| 7687740 | 7118-32 | 32 | 14 x 18 | 13 | 67.5 | 32.5 | 0.220 |

7212 / 7218

RECTANGULAR RING END FITTING

9x12-14x18

- › For accessing bolts in cramped and hard-to-reach locations, easy to change.
- › Forged.
- › Chrome Vanadium steel, matt chrome plated.
- › With eject-pin for unlocking.

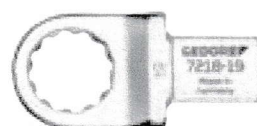

| Code | No. | mm | mm | mm | mm | Depth gauge | |
|---------|---------|----|--------|----|------|-------------|-------|
| 7691340 | 7212-07 | 7 | 9 x 12 | 8 | 13.0 | 17.5 | 0.030 |
| 7691420 | 7212-08 | 8 | 9 x 12 | 8 | 14.2 | 17.5 | 0.035 |
| 7691690 | 7212-10 | 10 | 9 x 12 | 8 | 17.2 | 17.5 | 0.040 |
| 7691770 | 7212-11 | 11 | 9 x 12 | 8 | 18.6 | 17.5 | 0.030 |
| 7677940 | 7212-12 | 12 | 9 x 12 | 12 | 20.0 | 17.5 | 0.035 |
| 7691930 | 7212-13 | 13 | 9 x 12 | 12 | 21.5 | 17.5 | 0.035 |
| 7692230 | 7212-14 | 14 | 9 x 12 | 12 | 23.0 | 17.5 | 0.040 |
| 7692580 | 7212-15 | 15 | 9 x 12 | 12 | 24.0 | 17.5 | 0.040 |
| 7678080 | 7212-16 | 16 | 9 x 12 | 13 | 26.0 | 17.5 | 0.040 |
| 7692740 | 7212-17 | 17 | 9 x 12 | 13 | 27.0 | 17.5 | 0.040 |
| 7678160 | 7212-18 | 18 | 9 x 12 | 13 | 28.5 | 17.5 | 0.040 |
| 7692820 | 7212-19 | 19 | 9 x 12 | 13 | 30.5 | 17.5 | 0.040 |
| 7678240 | 7212-21 | 21 | 9 x 12 | 15 | 33.0 | 17.5 | 0.040 |

| Code | No. | mm | mm | mm | mm | Depth gauge | |
|---------|---------|----|---------|------|------|-------------|-------|
| 7693120 | 7218-13 | 13 | 14 x 18 | 12.0 | 21.5 | 25 | 0.120 |
| 7693390 | 7218-14 | 14 | 14 x 18 | 12.0 | 23.0 | 25 | 0.120 |
| 7693470 | 7218-15 | 15 | 14 x 18 | 12.0 | 24.2 | 25 | 0.120 |
| 7678320 | 7218-16 | 16 | 14 x 18 | 12.0 | 25.7 | 25 | 0.125 |
| 7693630 | 7218-17 | 17 | 14 x 18 | 12.0 | 27.2 | 25 | 0.125 |
| 7678830 | 7218-18 | 18 | 14 x 18 | 12.0 | 28.5 | 25 | 0.125 |
| 7693710 | 7218-19 | 19 | 14 x 18 | 12.0 | 30.5 | 25 | 0.125 |
| 7678910 | 7218-21 | 21 | 14 x 18 | 15.0 | 33.0 | 25 | 0.140 |
| 7693980 | 7218-22 | 22 | 14 x 18 | 15.0 | 34.5 | 25 | 0.140 |
| 7694280 | 7218-24 | 24 | 14 x 18 | 15.0 | 37.5 | 25 | 0.140 |
| 7694440 | 7218-27 | 27 | 14 x 18 | 17.5 | 41.5 | 31 | 0.150 |
| 7694790 | 7218-30 | 30 | 14 x 18 | 17.5 | 45.0 | 31 | 0.160 |
| 7695920 | 7218-32 | 32 | 14 x 18 | 17.5 | 47.5 | 31 | 0.165 |

7412 / 7418

RECTANGULAR REVERSIBLE RATCHET HEAD

9x12-14x18

- For accessing bolts in cramped and hard-to-reach locations, easy to change.
- Forged.
- Chrome Vanadium steel, matt chrome plated.
- With eject-pin for unlocking.
- Fine-toothed.
- 7412 with return angle of 5 degrees
- 7418 with return angle of 7 degrees
- Maximum continuous load of ratchet according to DIN EN ISO 6789:2003 and/or maximum load of cavity.

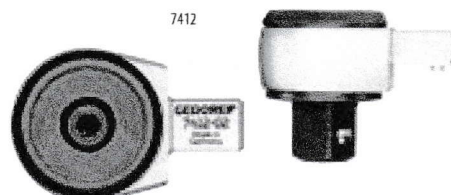
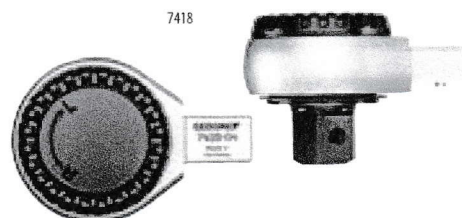

| Code | No. | ■" | □mm | mm ⁺ ₂ | ⊙mm | Depth gauge | ⚖ |
|----------------|---------|-----|--------|------------------------------|-----|-------------|-------|
| 7672710 | 7412-00 | 1/4 | 9 x 12 | 16.6 | 25 | 17.5 | 0.060 |
| 7686500 | 7412-01 | 3/8 | 9 x 12 | 23.2 | 34 | 17.5 | 0.140 |
| 7687230 | 7412-02 | 1/2 | 9 x 12 | 24.2 | 34 | 17.5 | 0.150 |

| Code | No. | ■" | □mm | mm ⁺ ₂ | ⊙mm | Depth gauge | ⚖ |
|----------------|---------|-----|---------|------------------------------|-----|-------------|-------|
| 7687580 | 7418-02 | 1/2 | 14 x 18 | 28.8 | 47 | 25 | 0.350 |
| 7687660 | 7418-04 | 3/4 | 14 x 18 | 35.5 | 64 | 33 | 0.780 |

754

RATCHET HEAD

1/2"-1"

- Enables controlled torque tightening in combination with a DREMOMETER torque wrench.
- Forged.
- Made from Chrome Vanadium steel.
- Fine-pitched, sturdy ratchet head.
- With 1/2", 3/4" and 1" output square drive.
- For clockwise tightening.

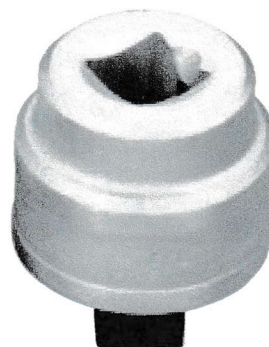

| Code | No. | ■" | ⚖ |
|----------------|--------|-----|-------|
| 7680650 | 754-02 | 1/2 | 0.350 |
| 7680730 | 754-04 | 3/4 | 1.00 |
| 7680810 | 754-06 | 1 | 2.50 |